

## Function

The SN range of Disc Brakes is a natural evolution of the SB range. The brake is designed with a floating caliper and can be activated by either a Brake Chamber to provide the service brake function or a Spring Brake to provide the service and parking brake functions.

For trailers with a wheel size of 22,5", an Air Disc Brake has been designed specifically for trailer applications. This brake is called **SK7...** and its main features are high fade resistance and low weight. Additionally, the **SK7...** has 2mm more brake pad thickness compared with the **SN6...** and **SN7...** versions.

## Main features

- Monobloc body
- Compact design
- Reduced weight
- Optimised sealing at the caliper to actuator interface and the fixed Guide Pin
- Optimised protection of the Guide Pins
- Interchangeability between SN and SB
- Possibility of pad wear control via Pad Wear Indicators

## Technical features

	SN5...	SN6...	SN7...	SK7...
Suitable for wheel rim size [inch]	17,5	19,5	22,5	22,5
Internal transmission ratio	10	15,6	15,6	15,6
Rotor disc diameter [mm]	335	377	430	430
Rotor disc thickness (new) [mm]	34	45	45	45
Rotor disc thickness (min) [mm]	28	37	37	37
Pad friction material thickness (new) [mm]	19	21	21	23
Pad friction material thickness (min) [mm]	2	2	2	2
Brake efficiency [%]	95	95	95	95
Weight without Disc, including pads [kg]	23	33,5	44,6	35,7
Seal Diaphragm (caliper to cylinder interface)	Yes	Yes	Yes	Yes

SN5...

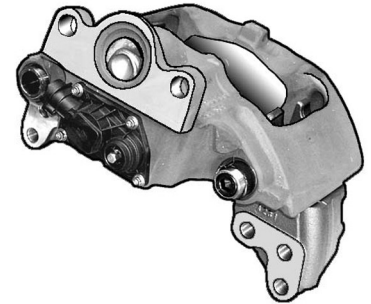

SN6..., SN7..., SK7...

